

Electric sprayer machine diagram (3)

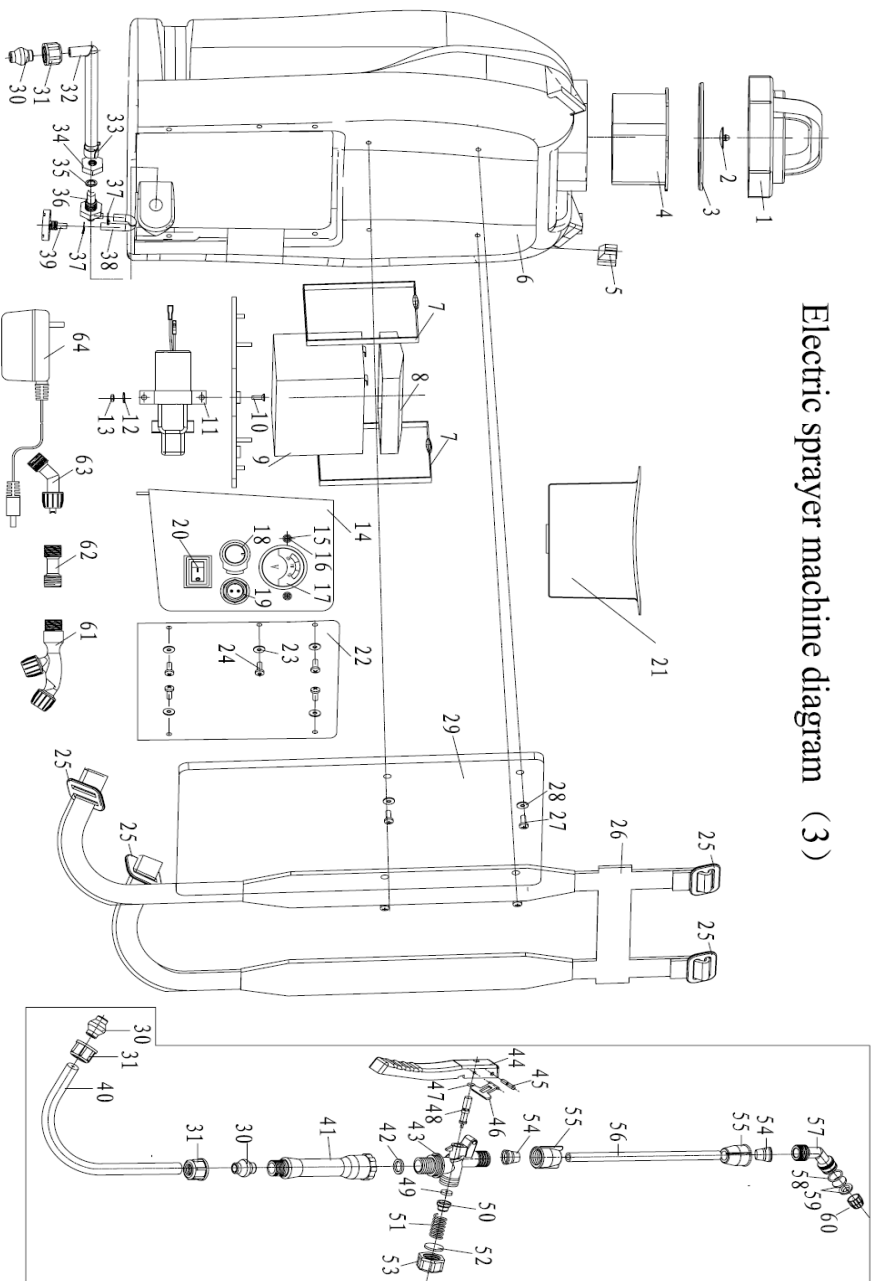

# Detailed Table

NO.	Part No.	Part Name	Qty.	NO.	Part No.	Part Name	Qty.	NO.	Part No.	Part Name	Qty.
1	WS-18D. 9-1	Container Cap	1	25	WS20-12-05	Fastening buckle	4	49	WS-18D. 5-3	Switch Felt Washer	1
2	WSJB-6. 2-2	Air Intake Plug	1	26	WS-18D. 7	Belt	1	50	WS-18D. 5-4	Washer seat	1
3	WS-18D. 9-2	Felt Washer	1	27	GB/T818	Screw M5×10	4	51	WS-18D. 5-5	Spring	1
4	WS-18D. 8	Large filter	1	28	GB/T96. 1	Washer φ6	4	52	WS-18D. 5-6	Switch Nut Washer	1
5	WS-18D-1	Round rod clamp	1	29	WS-18D. 6	Belt pad	1	53	WS-18D. 5-7	Switch Nut	1
6	WS-15DV/180A. 1	Water tank	1	30	WS16-13-08-02	Scarf joint	3	54	WS16-13-05-02B	Split Sleeve	2
7	WS-18D. 4. 2	The belt for battery	2	31	WS16-13-08-01B	Case nut M18	2	55	WS16-13-05-01	Case nut	2
8	WS-18D. 4-2	Lag	1	32	WS-18D-2A	Absorb pipe	1	56	WS16-13-05-03B	Round bar	1
9	WS-JN1270	Battery	1	33		Pipe buckle φ6~φ12	1	57	WS16-13-04B	Nozzle body	1
10	GB/7819. 1	Screw M4×18	2	34	WS-18DZ-1	Case nut	1	58	WS-18D. 11-2	Felt Washer	1
11	HELL-GMB-06	Pump	1	35	WS-18DZ. 1-4	Rubber Washe	1	59	WS16P-13-01-01	Conical Spray Plate	1
12	GB/197. 1	Washer φ4	2	36	WS-18DZ. 1-3	Water pipe	1	60	WS16-13-01-03	Spray Head Nut	1
13	GB/16170	Nut M4	2	37	WS-18DZ. 1-2	Snap link	2	61	WS-18D. 11	F Style Spray Head	1
14	WS-15DA. 2-1	Bead plate	1	38	WS-18DZ. 1-1	Water pipe	1	62	WS16-13-01C-03	Join	1
15	GB/1845	Screw ST2. 9X8	2	39	WS-18DZ. 1. 1	Little filter	1	63	WS16P-13-01B	Fan Style Spray Head	1
16	GB/1795	Washer φ3	2	40	WS-18D. 3-2	Hose	1	64	WS1212Z	Charger	1
17	WS-20D. 2	Volmeter	1	41	WS-18D. 5-13	Switch Handle	1				
18	WS-15DA. 2. 1	Voltage regu lator	1	42	WS-18D. 5-12	Felt Washer	1				
19	WS-15DA. 2. 2	The line forre changing	1	43	WS-18D. 5-1	Switch Body	1				
20	KCD3-1111N	Power switch	1	44	WS-18D. 5-8	Press Plate	1				
21	WS-15DA-1	Pump board	1	45	WS-18D. 5-10	Switch Pin	1				
22	WS-15DA-2	Cover plate	1	46	WS-18D. 5-9	Lock catch	1				
23	GB/7818	Screw M5×10	5	47	GB/T3452. 1	O-Ring 4. 4×1. 8	1				
24	GB/197. 1	Washer φ5	5	48	WS-18D. 5-2	Pressure shaft	1				